

SHEET 77

SHEET 20

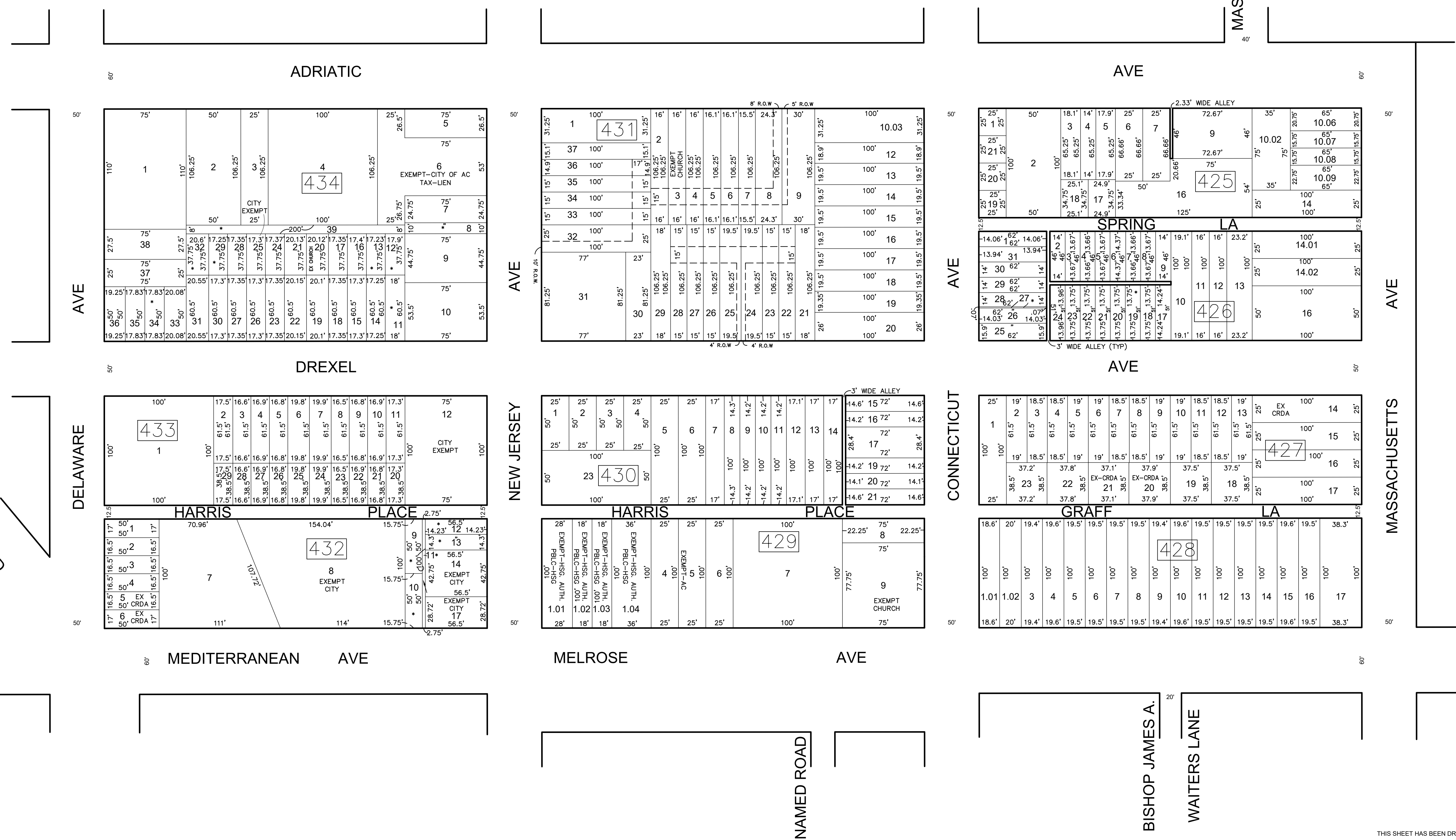

REVISIONS				
DATE	BY	LIC. NO.	BLOCK	LOT
08/2013	CHARLES A. ATKINSON-ARH	33994	430	17
09/2013	CHARLES A. ATKINSON-ARH	33994	433	13
03/2014	CHARLES A. ATKINSON-ARH	33994	425	10,06
03/2014	CHARLES A. ATKINSON-ARH	33994	433	12
04/2019	ED CLAY	34842	426	32
04/2019	ED CLAY	34842	425	8
04/2019	ED CLAY	34842	430	22

LEGEND:
 * - EXEMPT: CITY OF ATLANTIC CITY

SHEET 75

THIS MAP HAS BEEN GIVEN A FORMAL CERTIFICATION BY THE DIVISION OF TAXATION ON NOVEMBER 25, 1997, SIGNED BY WILLIAM H. BLACK, CTA AND ASSIGNED SERIAL NUMBER 778

TAX MAP
 CITY OF ATLANTIC CITY
 ATLANTIC COUNTY, NEW JERSEY
 SCALE: 1" = 50'
 DATE: AUG 1995
 JOSEPH M DOLAN, PLS, PP
 MUNICIPAL LAND SURVEYOR
 NEW JERSEY LICENSE NO. 23930
 OFFICE OF THE CITY ENGINEER
 603 CITY HALL
 ATLANTIC CITY, NEW JERSEY 08401

TO SHOW CONDITIONS AS OF MAY 2019

COA# 24GA27973300